

PORT MELBOURNE 18 Park Square

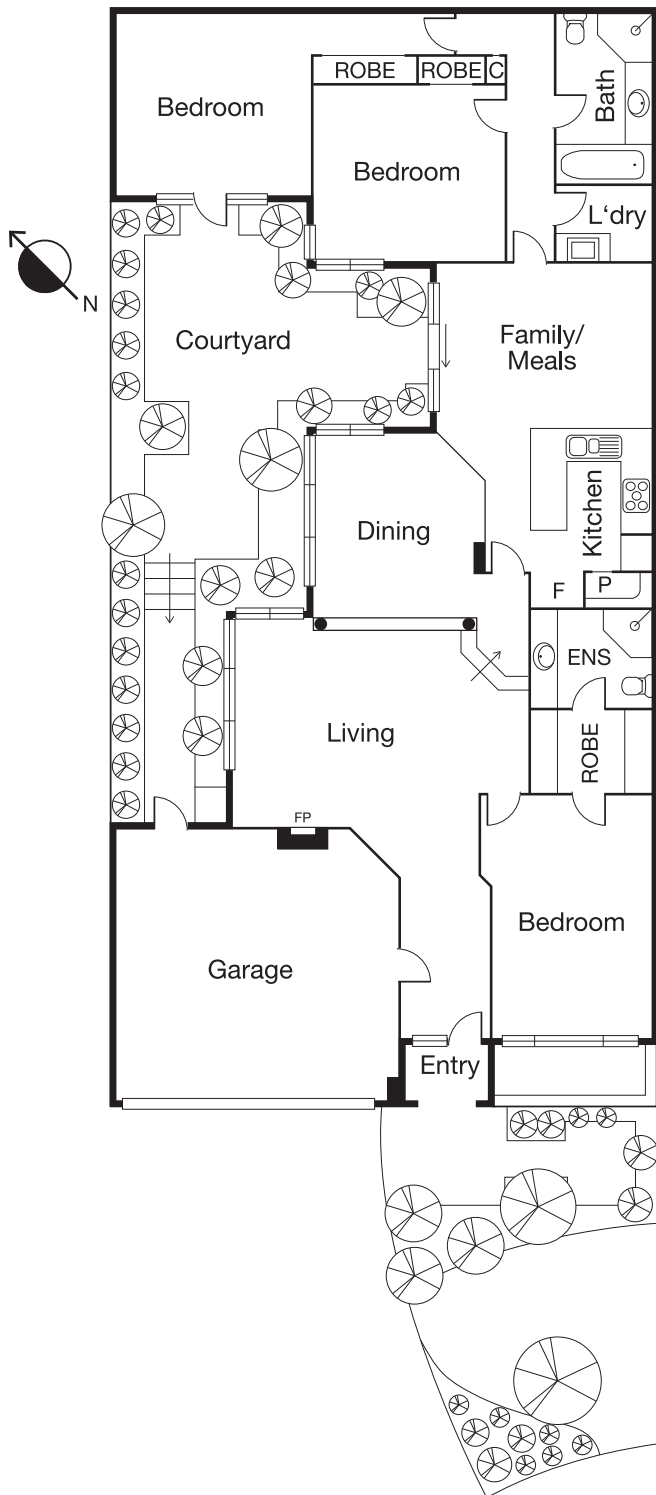

CAYZER



SINGLE LEVEL LIVING

- New carpets, timber flooring, ducted heating and cooling, gas fireplace
- Prized location moments from everything
- Exceptionally well kept/presented on a 280 sqm allotment (approx)

This single level residence set back from the street offers security and privacy opposite beautiful parklands and is to be a sure winner. A unique offering for families or downsizers, comprising spacious living and dining zones, appointed modern kitchen to family room and sun-filled internal established courtyard garden boasting fruit trees.

The super large main bedroom comes with walk in robes and full ensuite, and the two further bedrooms each with built-in robes look onto the delightful internal courtyard garden. There is a central family sized bathroom and separate laundry. The double garage provides for direct access into the home along with a separate door to the courtyard.

3	2.5	2
Auction	Saturday 16 November at 11.30am	
Inspection	As advertised or by appointment	
Contact	Michael Szulc	0417 122 809
	Jordan Gravestain	0448 250 193
Mel Ref	57 A3	



Interactive Floorplan